



SCHEDA PROFILI
COMPATIBILI IKEA

1. Impiallacciato
2. Laccato
3. Pvc
4. Fenix
5. Laminato HPL

PROFILES DATA SHEET
IKEA COMPATIBLE

1. Veneered doors
2. Lacquered doors
3. Polymer doors
4. Fenix doors
5. HPL laminate doors

SLAB*

Spessori disponibili 22 mm.

Available thickness 22 mm.

Stärke 22 mm.

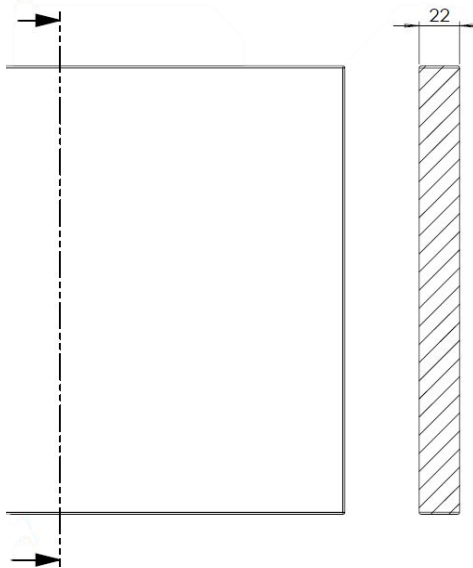

* Per le finiture lucide lo spessore aumenta di 1 mm

* For the high gloss finishes the thickness needs to be increased of 1 mm

* Für die Hochglanz Ausführungen muss die Stärke um 1 mm erhöht werden

SLAB

Spessori disponibili 22 mm.

Available thickness 22 mm.

Stärke 22 mm.

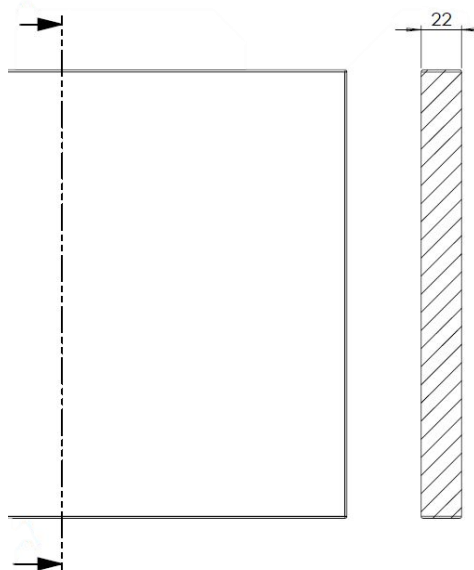

GOLA 1 / JPULL

Spessori disponibili 22 mm.

Available thickness 22 mm.

Stärke 22 mm.

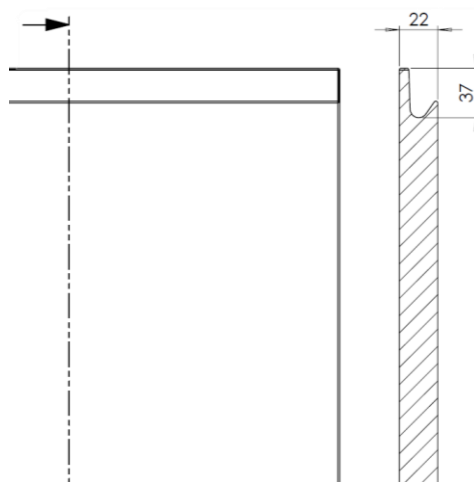

SLAB

Spessori disponibili 22 mm.
Anta a vetro con montante da 75mm.
Scasso anta vetro 7 x h 12 mm.

Available thicknesses 22 mm.
Glass door with 75mm style.
Rebate for glass door 7 x h 12 mm

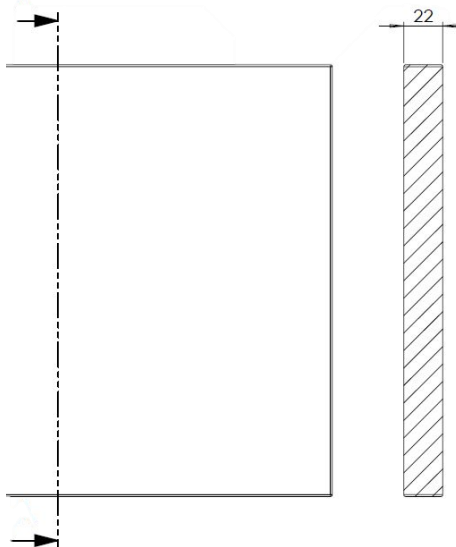

POIGNÉE

Spessori disponibili 22 mm.
Anta vetro non disponibile.
Pezzo massimo realizzabile 2490 x 1230 x 22.
Disponibilità di fare la maniglia sia in orizzontale sia in verticale, su 2 lati.
Larghezza minima realizzabile sul lato maniglia 140mm.

Door thickness 22 mm.
Glass door not available.
Maximum available piece 2490 x 1230 x 22.
Handle can be vertical or horizontal, on both sides.
Minimum width to have the handle is 140mm.

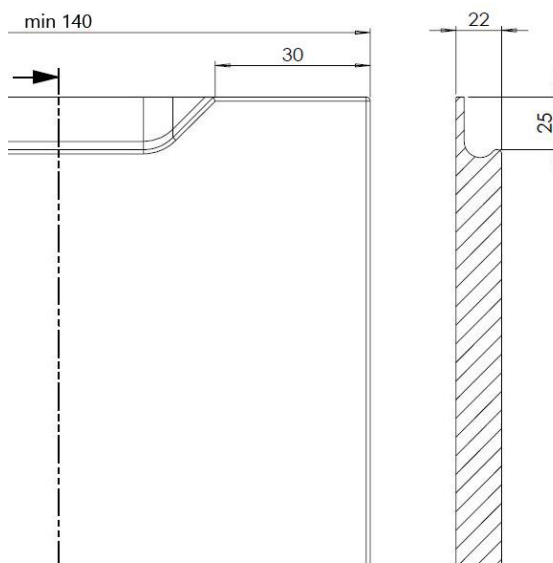

SLAB

Spessori disponibili 22 mm.

Available thickness 22 mm.

Stärke 22 mm.

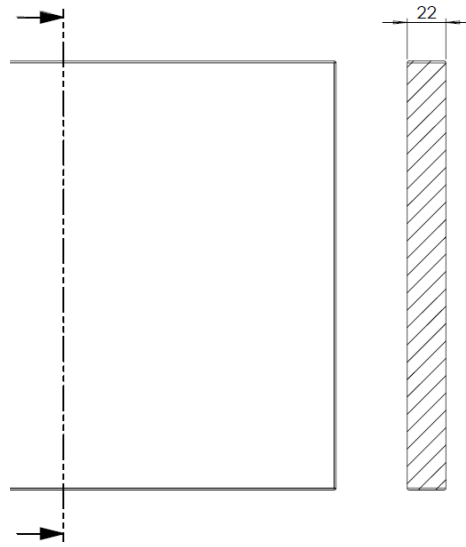

SLAB

Spessori disponibili 22 mm.

Available thickness 22 mm.

Stärke 22 mm.

